

PREMIUM

— EST. 1956 —

 LIPPERT®

AXLE PARTS

LIPPERT

11W

1260031

**INTENTIONALLY LEFT BLANK  
FOR TWO-PAGE VIEWING**



# TRAILER AXLES FAST AND EASY

EASY ONLINE  
ORDERING

ASSEMBLED  
IN THE USA

FREE & FAST  
SHIPPING\*

**QUALITY AXLES,  
QUICK DELIVERY.**

**TRUST THE BRAND THAT MANUFACTURES OVER  
3,000 SPRING & TORSION AXLES EVERY DAY.**



LIMITED 1-YEAR warranty on grease and oil seals for all axles

LIMITED 6-YEAR warranty on spring axle welds and suspension systems

LIMITED 11-YEAR warranty on torsion axle welds and suspension components

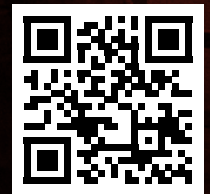

PLACE YOUR AXLE  
ORDER TODAY!

\*Most common utility trailer axles ship same or next business day (24-hour axle program).  
Custom axles and stocking orders of four or more axles may have a longer lead time.

Connect with us      

# TRAILER AXLE SOLUTIONS

Since 2005, we've been a leading axle supplier to the utility trailer parts and recreational vehicle industries. Our trailer axles are engineered and constructed with cutting-edge technology, making them among the best in terms of quality and durability.

Our state-of-the-art robotic welders ensure the highest precision on every component you buy, leaving you with peace of mind on the road ahead. Plus, we make our replacement cargo axle assemblies and components traceable, giving us optimum product visibility and serviceability for your convenience.



## Benefits of Lippert Axles



### Robotic Welding

We utilize robotic welding for consistent, fully penetrated welds every time.

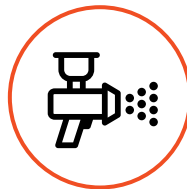

### Durable Finish

Powder-coated axle tube finish prevents premature corrosion from road salt and other chemicals.



### Exceptional Quality

Our axles are QAI-certified to CSA Standard CAN3-D313-M85 for exceptional quality.

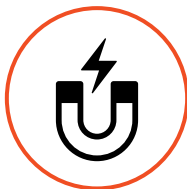

### Magnet-Amp Checked

Each axle is magnet-amp checked for proper function in all wiring.



### Aluminum Alloy Valcrum Caps

Aluminum alloy, upgraded Valcrum premium oil bath caps will not crack like plastic oil caps.

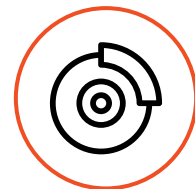

### Multiple Brake Options

We offer standard electric, forward self-adjusting and hydraulic brakes for your replacement axle.

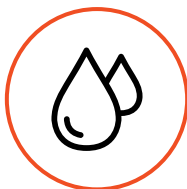

### Waterproof Electrical Wiring Connections

Protected connections help prevent corrosion and ensure long-term performance.



### Super Lube Lubrication System

This system saves time, requiring no disassembly and filling the entire bearing cavity with grease, allowing for complete submersion. This system offers better long-term protection over standard hubs.



## TORSION AXLES

- Requires less maintenance than spring axles
- Rubberized torsion beam and cords absorb road shock and vibrations for a quiet, smooth ride
- Available in square and diamond orientations
- Various starting angles control trailer height
- Independent wheel suspension



Diamond pattern torsion axle



Square pattern torsion axle



## SPRING AXLES

- Integrated, one-piece spindle flange
- Straight or drop spindles
- Slipper or double-eye leaf spring suspension
- Standard or upgraded equalized suspension



Feature	Torsion Axles	Spring Axles
Warranty	11-year	6-year
Axle configuration	Single, tandem	Single, tandem, triple
Axle capacity	2K - 7K (diamond) / 2K - 12K (square)	2K - 16K
Idler axles	2K - 8K	2K - 8K
CSA certification	2K - 8K	2K - 8K
Valcrum premium oil caps (included)	8K - 12K	8K - 16K
Oil bath (option)	7K - 12K	7K - 16K
Forward self-adjusting brakes (option)	3.5K - 12K	3.5K - 16K
Hutch HD suspension system (option)	--	10K - 16K
Super lube lubrication system (option)	2K - 8K	2K - 8K

# BUILD YOUR OWN AXLE

In crafting our axle assemblies, we assign part numbers that delineate the characteristics of each component. These numbers correspond to the axle capacity, beam type, hub face dimension, spring center dimension, tie plate type, spring mounting type, lubrication type, bolt pattern, leaf spring type and pigtail type. The foundational structure of our part numbering system is outlined below.

## Example Axle Number

LCI60-SB-86.5-68.5-NOSP-OS-L-65517-7226-30PT

Example Axle Number Breakdown & Definitions									
Model	Spindle and Brake	Hub Face Dimension	Spring Center Dimension	Tie Plate	Spring Mounting	Lubrication	Hub or Hub / Drum	Leaf Spring	Pigtail Type
LCI60	SB	86.5	68.5	NOSP	OS	L	65517	7226	30PT

## Axle Number Breakdown, Definitions & Options

Model	
Code	Description
LCI20	2,000 lbs.
LCI35	3,500 lbs.
LCI44	4,400 lbs.
LCI52	5,200 lbs.
LCI60	6,000 lbs.
LCI70	7,000 lbs.
LCI80H (hybrid)	8,000 lbs.
LCI80	8,000 lbs.
LCI100S (short)	10,000 lbs.
LCI120	12,000 lbs.
LCI160	16,000 lbs.

Spindle and Brake	
Code	Description
<b>Spindles</b>	
S	Straight spindle
D	4" drop spindle
<b>Brakes</b>	
B	Electric drum brake
BSA	Electric drum brake, self-adjust
I	Idler hub, no brake
HUSFB	Hydraulic uni-servo drum brake, free backing
AB	Air brake
D	Hydraulic disc brake

Hub Face Dimension
Distance between wheel mounting surfaces of hubs

Spring Center Dimension	
Code	Description
NOSS	No spring seats welded
Distance between spring centers	

Tie Plate	
Code	Description
NOSP	Standard tie plate
FIXSS	Fixed spring seats, both sides (10K - 16K)
ADJSS	One fixed and one adjustable spring seat (10K - 16K)
HUTSS	HD suspension system spring seat, welded (10K - 16K)

Spring Mounting	
Code	Description
OS	Overslung, on top of axle tube
US	Underslung, underneath axle tube

Lubrication	
Code	Description
L	Super-lube
G	Standard grease
O	Oil lubrication

Hub or Hub / Drum	
Code	Bolt Pattern
440	4 on 4"
545	5 on 4-1/2"
5475	5 on 4-3/4"
550	5 on 5"
555	5 on 5-1/2"
655	6 on 5-1/2"
660	6 on 6"
86517	8 on 6-1/2", 1/2" studs
86537	8 on 6-1/2", 9/16" studs
86580-9/16	8 on 6-1/2", 9/16" stud, 8K
86580-5/8	8 on 6-1/2", 5/8" stud, 8K
865	8 on 6-1/2", 5/8" studs, 10K - 12K
8/275	8 on 275 mm, 16K

Leaf Spring
Industry number, see page 22

Pigtail Type	
Code	Description
18PT	18" pigtails
30PT	30" pigtails

# PREMIUM AXLE PARTS RETAIL PROGRAM

Lippert is your ultimate one-stop shop for axle parts and components. Our comprehensive offering features premium replacement parts meticulously crafted to meet the highest standards of quality and reliability. Whether you need bearings, hubs, brakes or any other vital component, we offer exceptional performance and durability. These parts are readily available through Lippert, CURT or one of our many distribution partners across the country.

See pages 6 and 7 for part numbers.

**Receive an in-store marketing package with your first qualifying purchase of premium Lippert retail packaged parts!**



Header Card (3', 4', or 8')

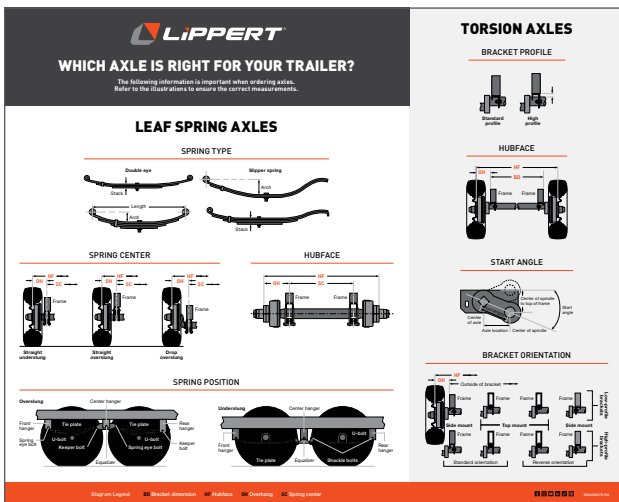

Counter Mat (20" x 16")



Metal Sign (29-1/2")

# GETTING YOU BACK ON THE ROAD AGAIN





# PREMIUM AXLE PARTS RETAIL PROGRAM



## BRAKE ASSEMBLIES

Retail Box #	Brake Size	Vehicle Side	Axle Capacity	Adjust.
297956	10" x 2-1/4"	Driver	3,500 lbs.	Manual
298274	10" x 2-1/4"	Passenger	3,500 lbs.	Manual
296649	10" x 2-1/4"	Driver	3,500 lbs.	Self
296650	10" x 2-1/4"	Passenger	3,500 lbs.	Self
298275	12" x 2"	Driver	4,000 - 8,000 lbs.	Manual
298276	12" x 2"	Passenger	4,000 - 8,000 lbs.	Manual
296651	12" x 2"	Driver	4,000 - 8,000 lbs.	Self
296652	12" x 2"	Passenger	4,000 - 8,000 lbs.	Self

## BRAKE & IDLER HUB KITS

Retail Kit #	Axle Capacity	Brake Hub Size	Bolt Pattern	Stud Size
<b>Brake Hubs</b>				
2024013264	3,500 lbs.	10"	5 on 4-1/2"	1/2"
2024013262	6,000 lbs.	12"	6 on 5-1/2"	1/2"
2024013260	7,000 lbs.	12"	8 on 6-1/2"	1/2"
2024013261	7,000 lbs.	12"	8 on 6-1/2"	9/16"
<b>Idler Hubs</b>				
2024013263	3,500 lbs.	--	5 on 4-1/2"	1/2"
2024044866	3,500 lbs.	--	5 on 5"	1/2"

Includes bearing kit (installed) and greased, lubed dust cap, cotter pin, castle nut, washer, lug nuts; in a full color retail box



2023134018

2023134654



2023134658

2023134661

2023134012

## GREASE & OIL SEALS

Retail Clamshell #	Axle Capacity	Spindle Shaft Diameter
<b>Grease Seals</b>		
2023134653	2,200 lbs.	1.5"
2023134654	3,500 lbs.	1.719"
2023134655	5,200 - 8,000 lbs.	2.25"
<b>Oil Seals</b>		
2023134018	5,200 - 8,000 lbs.	2.250"
2023134019	10,000 lbs.	2.875"
2023134020	12,000 - 16,000 lbs.	3.125"

## STANDARD DUST CAPS

Non Lubed Clamshell #	Lubed Clamshell #	Axle Capacity	Bore Size
<b>Dust Caps</b>			
2023134658	2023134661	2,000 - 3,500 lbs.	2"
2023134659	2023134662	5,200 - 6,000 lbs.	2-1/2"
2023134660	2023134011	7,000 - 8,000 lbs.	2-3/4"
<b>Retail Clamshell #</b>	<b>For Use With</b>		
<b>Dust Cap Rubber Plug</b>			
2023134012	Standard lubed dust caps		

# PREMIUM AXLE PARTS RETAIL PROGRAM



2023133979



2023133984

## BEARING KITS

Retail Package Kit #	Axle Capacity
<b>Clamshell</b>	
2023133979	2,000 lbs.
2023133980	3,500 lbs.
2023133981	5,200 lbs.
2023133982	6,000 lbs.
2023133983	7,000 lbs.

Retail Package Kit #	Axle Capacity
<b>Retail Box</b>	
2023133984	8,000 lbs.
2023133985	10,000 lbs.
2023133986	12,000 - 16,000 lbs.



2023134021



2024039634



2023134013

## SPINDLE & LUG NUT KITS

Retail Clamshell #	Axle Capacity	Washers Included
<b>Spindle Nut Kits</b>		
2023134656	2,000 - 8,000 lbs.	1" round
2023134657	2,000 - 8,000 lbs.	1" D-flat / 1" locking tang
2023134021	10,000 lbs.	1-1/2" round
2023134022	12,000 - 16,000 lbs.	1-7/8" round
<b>Lug Nut Kits</b>		
2024039632	60° cone wheel	1/2"-20
2024039633	60° cone wheel	9/16"-18
2024039634	Hex flange	5/8"-18
2024039635	Swiveling flange	5/8"-18

## WHEEL STUDS

Retail Clamshell #	Shoulder Length	Thread End
2023134013	2"	1/2"-20
2023134014	2-5/16"	9/16"-18



## ELECTRIC BRAKE ASSEMBLIES

Universally compatible  
with Dexter

- Standard electric brake assembly with park
- Easy, do-it-yourself installation
- Hardware sold separately



389875



297956 / 122258



298275 / 122259

Single Retail Box #	Single Brown Box #	Bulk Pallet #	Pallet Qty	Brake Size	Vehicle Side	Bolt Pattern	Axle Capacity	Adjustment
--	389875	--	--	7" x 1-1/4"	Driver / left	Four-bolt	2,200 lbs.	Manual
--	389876	--	--	7" x 1-1/4"	Passenger / right	Four-bolt	2,200 lbs.	Manual
297956	--	122258	168	10" x 2-1/4"	Driver / left	Four-bolt	3,500 lbs.	Manual
298274	--	122450	168	10" x 2-1/4"	Passenger / right	Four-bolt	3,500 lbs.	Manual
--	2024028244	346566	168	10" x 2-1/4"	Driver / left	Four-bolt	4,400 lbs.	Manual
--	2024028245	3465661	168	10" x 2-1/4"	Passenger / right	Four-bolt	4,400 lbs.	Manual
298275	--	122259	126	12" x 2"	Driver / left	Five-bolt	4,000 - 8,000 lbs.	Manual
298276	--	122451	126	12" x 2"	Passenger / right	Five-bolt	4,000 - 8,000 lbs.	Manual

# FORWARD SELF-ADJUSTING BRAKE ASSEMBLIES

Universally compatible with Dexter

- Lippert genuine replacement part
- Brakes self-adjust during every forward stop, providing up to 50% better braking distance
- Helps prevent premature brake line and magnet wear for safer travels
- With no actuator or hydraulic lines, installation is easier than hydraulic brakes
- Electric actuator (sold separately)



296649 / 1222583



296651 / 1222593

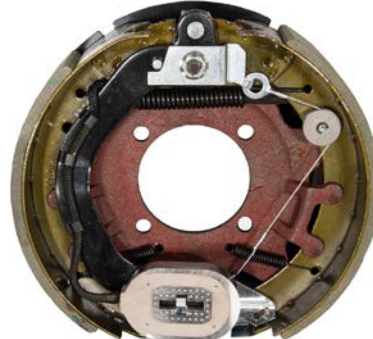

298277 / 156443

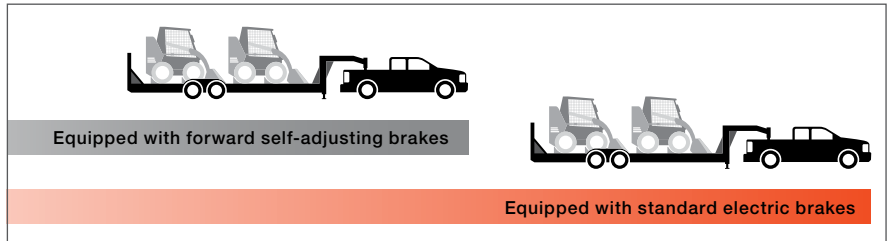

Go with the name you trust and have peace of mind knowing you're traveling with a genuine Lippert replacement part

Brakes self-adjust during every forward stop, so you can safely brake during emergency stops. They provide optimal brake performance by correcting clearance during every stop. They also prevent premature brake line and magnet wear, which will save you money over the long haul

Single Retail Box #	Single Brown Box #	Bulk Pallet #	Pallet Qty	Brake Size	Vehicle Side	Bolt Pattern	Axle Capacity	Adjustment
296649	--	1222583	168	10" x 2-1/4"	Driver / left	Four	3,500 lbs.	Self-adjust
296650	--	1224503	168	10" x 2-1/4"	Passenger / right	Four	3,500 lbs.	Self-adjust
--	2024028246	361585	168	10" x 2-1/4"	Driver / left	Four	4,400 lbs.	Self-adjust
--	2024028247	3615851	168	10" x 2-1/4"	Passenger / right	Four	4,400 lbs.	Self-adjust
296651	--	1222593	126	12" x 2"	Driver / left	Five	4,000 - 8,000 lbs.	Self-adjust
296652	--	1224513	126	12" x 2"	Passenger / right	Five	4,000 - 8,000 lbs.	Self-adjust
Coming soon	298277	2022004549	81	12-1/4" x 3-3/8"	Driver / left	Four	8,000 lbs.	Self-adjust
Coming soon	298279	2022004550	81	12-1/4" x 3-3/8"	Passenger / right	Four	8,000 lbs.	Self-adjust
Coming soon	2024028240	181935	81	12-1/4" x 3-3/8"	Driver / left	Seven	10,000 lbs.	Self-adjust
Coming soon	2024028241	181936	81	12-1/4" x 3-3/8"	Passenger / right	Seven	10,000 lbs.	Self-adjust
Coming soon	2024028242	297998	63	12-1/4" x 5"	Driver / left	Seven	12,000 - 16,000 lbs.	Self-adjust
Coming soon	2024028243	2979981	63	12-1/4" x 5"	Passenger / right	Seven	12,000 - 16,000 lbs.	Self-adjust

# ELECTRIC BRAKE REPLACEMENT COMPONENTS

## Shoe and lining kits

- Includes primary and secondary shoe and lining



136451



136444

Part #	Vehicle Side	Adjustment	Brake Size
136451	Universal	Manual	10" x 2-1/4"
334312	Driver / left	Self-adjusting	10" x 2-1/4"
334313	Passenger / right	Self-adjusting	10" x 2-1/4"
136444	Universal	Manual	12" x 2"
334314	Driver / left	Self-adjusting	12" x 2"
334316	Passenger / right	Self-adjusting	12" x 2"
330792	Driver / left	Self-adjusting	12-1/4" x 3-3/8"
3307921	Passenger / right	Self-adjusting	12-1/4" x 3-3/8"
330793	Driver / left	Self-adjusting	12-1/4" x 5"
3307931	Passenger / right	Self-adjusting	12-1/4" x 5"

## Magnet Kits



136454



136447



293115



136453

Part #	Fits Brake Size	Description	Lead Wire Color	Kit Includes
136454	10" x 2-1/4"	Magnet kit	Green	Magnet with lead wires, retainer clip and spring
136447	12" x 2"	Magnet kit	Black	Magnet with lead wires, retainer clip and spring
293115	12-1/4"	Magnet Kit	Yellow	Magnet with lead wires, retainer clip and spring
136453	10" and 12"	Adjuster screw and spring kit	--	Adjustment screw and spring for manual adjust brakes





## BRAKE HUB ASSEMBLIES & KITS

Universally compatible with Dexter

- Lippert genuine replacement part
- Allows for electric or hydraulic drum brakes
- Races and wheel studs come pre-installed
- Accepts press-in dust caps
- Durable, cast iron construction
- Backed by a 1-year warranty



134206



814209



2024013264

Axle Capacity	Brake Hub Size	Bolt Pattern	Wheel Size	Stud Size	Complete Retail Kit Config A #	Complete Retail Kit Config B #	Raw w/ Bearing Kit #	Raw Single Brown Box #	Raw Bulk Pallet #	Pallet Qty	Bearing Kit #
2,200 lbs.	7"	5 on 4-1/2"	10" - 13"	1/2"	--	--	814209	2024029076	134206	125	333948
3,500 lbs.	10"	5 on 4-1/2"	12" - 15"	1/2"	2024013264	814200	814210	2024029077	126003	72	333948
4,400 lbs.	10"	6 on 5-1/2"	14" - 15"	1/2"	--	--	141286	2024029078	136214	75	333948
6,000 lbs.	12"	6 on 5-1/2"	15" - 16"	1/2"	2024013262	814202	814211	2024029080	122094	63	333950
7,000 lbs.	12"	8 on 6-1/2"	16"	1/2"	2024013260	814203	814212	2024029081	122096	45	333951
7,000 lbs.	12"	8 on 6-1/2"	16" - 17-1/2"	9/16"	2024013261	814204	814213	2024029082	134543	45	333951

**Complete retail kit (Config A):** includes bearing kit (installed) and greased, lubed dust cap, cotter pin, castle nut, washer, lug nuts; in a full color retail box

**Complete retail kit (Config B):** includes bearing kit (installed) and greased; in a full color retail box

**Raw single with bearing kit:** includes bearing kit specified in table above (not installed); individually brown boxed

**Raw single brown box:** individually brown boxed

**Raw bulk pallet:** on a pallet in the specified quantity

# THREADED BRAKE HUB ASSEMBLIES

Universally compatible with Dexter

- Lippert genuine replacement part
- Allows for electric or hydraulic drum brakes
- Races and wheel studs come pre-installed
- Accepts Valcrum threaded dust caps
- Durable, cast iron construction
- Backed by a 1-year warranty

Axle Capacity	Brake Hub Size	Bolt Pattern	Wheel Size	Stud Size	Raw Single Grease #	Raw Single Oil #	Raw Single Brown Box #	Raw Bulk Pallet #	Pallet Qty
<b>Standard</b>									
8,000 lbs.	12-1/4"	8 on 6-1/2"	16" - 17-1/2"	9/16"	148629	341279	2024029084	2772101	45
8,000 lbs.	12-1/4"	8 on 6-1/2"	17-1/2"	5/8"	148627	341280	2024029085	2772121	45
10,000 lbs.	12-1/4"	8 on 6-1/2"	16" - 17-1/2"	5/8"	--	184046	2024029083	183662	TBD
10,000 lbs.	12-1/4"	8 on 6-1/2"	16" - 17-1/2"	5/8"	2021093229*	791400*	2024029092	791399*	36
12,000 lbs.	12-1/4"	8 on 6-1/2"	16" - 17-1/2"	5/8"	2021093160	298135	2024029086	297983	27
16,000 lbs.	12-1/4"	8 on 275 mm	17-1/2"	M22	2021092557	353325	2024029090	353323	TBD
<b>Hybrid</b>									
8,000 lbs.	12"	8 on 6-1/2"	16" - 17-1/2"	9/16"	380827	380828	2024029091	359552	45
8,000 lbs.	12"	8 on 6-1/2"	17-1/2"	5/8"	243185	347635	2024029088	347627	45

\* Indicates short design (current standard)  
**Raw grease:** includes inner bearing and seal, greased (installed)  
**Raw oil:** includes inner bearing and seal (installed)  
**Raw single brown box:** individually brown boxed  
**Raw bulk pallet:** on a pallet in the specified quantity  
**Note:** 8K includes outer bearing and 10K - 16K does not include outer bearing

# BRAKE DRUMS

Universally compatible with Dexter

- Lippert genuine replacement part
- Allows for electric or hydraulic drum brakes
- Durable, cast iron construction
- Backed by a 1-year warranty

Axle Capacity	Brake Size	Brake Width	Raw Bulk Pallet #	Pallet Qty
10,000 lbs.	12-1/4"	3-3/8"	183537	45
10,000 lbs.	12-1/4"	3-3/8"	791397*	45
12,000 - 16,000 lbs.	12-1/4"	5"	696690	45

\* Indicates short design (current standard)  
**Raw bulk pallet:** on a pallet in the specified quantity



# IDLER HUB ASSEMBLIES & KITS

Universally compatible with Dexter

- Lippert genuine replacement part
- Does not allow for a trailer braking system
- Races and wheel studs come pre-installed
- Accepts press-in dust caps
- Durable, cast iron construction
- Backed by a 1-year warranty



134574



814206



814198



2024013263

Axle Capacity	Bolt Pattern	Hub Flange Diam.	Wheel Size	Stud Size	Complete Retail Kit Config A #	Complete Retail Kit Config B #	Raw w/ Bearing Kit #	Raw Single Brown Box #	Raw Bulk Pal. #	Pal. Qty	Bearing Kit #
2,200 lbs.	4 on 4"	--	8" - 12"	1/2"	--	814197	814206	2024029106	134574	98	2023133979
2,200 lbs.	5 on 4-1/2"	5-1/2"	8" - 12"	1/2"	--	814198	814207	2024029105	134332	98	2023133979
2,200 lbs.	5 on 4-1/2"	6-1/2"	13" - 15"	1/2"	--	814196	814205	2024029111	158529	70	2023133979
3,500 lbs.	5 on 4-1/2"	--	13" - 15"	1/2"	2024013263	814199	814208	2024029104	122098	72	333948
3,500 lbs.	5 on 5"	--	13" - 15"	1/2"	2024044866	--	141287	2024029109	137860	45	333948
4,400 lbs.	6 on 5-1/2"	--	14" - 15"	1/2"	--	144604	--	2024029110	144603	180	333948
6,000 lbs.	6 on 5-1/2"	--	15" - 16"	1/2"	--	--	141288	2024029108	137859	150	333950
7,000 lbs.	8 on 6-1/2"	--	16"	1/2"	--	--	141291	2024029107	137830	200	333951
7,000 lbs.	8 on 6-1/2"	--	16"	9/16"	--	--	427443	2024029116	373464	TBD	333951

**Complete retail kit (Config A):** includes bearing kit (installed) and greased, lubed dust cap, cotter pin, castle nut, washer, lug nuts; in a full color retail box

**Complete retail kit (Config B):** includes bearing kit (installed) and greased; in a full color retail box

**Raw single with bearing kit:** includes bearing kit specified in table above (not installed); individually brown boxed

**Raw single:** includes races and wheel studs; individually brown boxed

**Raw bulk pallet:** includes races and wheel studs; on a pallet in the specified quantity



## THREADED IDLER HUB ASSEMBLIES

Universally compatible with Dexter

- Lippert genuine replacement part
- Does not allow for a trailer braking system
- Races and wheel studs come pre-installed
- Accepts Valcrom threaded dust caps
- Durable, cast iron construction
- Backed by a 1-year warranty

Axle Capacity	Bolt Pattern	Wheel Size	Stud Size	Raw Grease #	Raw Oil #	Raw Single Brown Box #	Raw Bulk Pallet #	Pallet Qty
8,000 lbs.	8 on 6-1/2"	16" - 17-1/2"	9/16"	674364	674748	2024029117	673602	TBD
8,000 lbs.	8 on 6-1/2"	17-1/2"	5/8"	717391	717392	2024029118	717390	TBD
10,000 lbs.	8 on 6-1/2"	16" - 17-1/2"	5/8"	2021093253*	791401*	2024029119	791398*	54
12,000 lbs.	8 on 6-1/2"	16" - 17-1/2"	5/8"	2021093200	696691	2024029112	301691	TBD
16,000 lbs.	8 on 275 mm	17-1/2"	M22	2021092679	2020111549	2024029115	352777	TBD

**Raw grease:** includes inner bearing and seal, greased (installed)

**Raw oil:** includes inner bearing and seal (installed)

**Raw single brown box:** individually brown boxed

**Raw bulk pallet:** on a pallet in the specified quantity

**Note:** 8K includes outer bearing and 10K - 16K does not include outer bearing

\* Indicates short design (current standard)

# DISC BRAKE CONVERSION KITS

Disc brakes offer superior performance and eliminate the limitations of drum brakes. Standout advantages include easy inspection without wheel removal, self-adjusting capabilities and simplified maintenance.

With unmatched braking performance and reduced maintenance hassle, their innovative design ensures consistent stopping power with increased resistance to brake fade. In addition, users can enjoy reduced unsprung weight for a smoother ride and enhanced brake pedal feel for precise control.

## Each kit includes

- Caliper brackets
- Caliper assemblies with pads and fittings
- Rotor assemblies
- Electric over hydraulic actuator (1,600 PSI)
- Brake line plumbing kit



Part #	Axle Capacity	Oil Bath	Axle Configuration	Stud Size	Bolt Pattern	Brake Flange Mounting Pattern
<b>Standard Conversion Kits</b>						
688768	5,200 - 6,000 lbs.	No	Tandem	1/2"	6 on 5-1/2"	Five-bolt
688789	5,200 - 6,000 lbs.	No	Triple	1/2"	6 on 5-1/2"	Five-bolt
689410	8,000 lbs.	No	Tandem	9/16"	8 on 6-1/2"	Four-bolt
689413	8,000 lbs.	No	Triple	9/16"	8 on 6-1/2"	Four-bolt
689421	8,000 lbs.	No	Tandem	5/8"	8 on 6-1/2"	Four-bolt
689423	8,000 lbs.	No	Triple	5/8"	8 on 6-1/2"	Four-bolt
689464	8,000 lbs.	Yes	Tandem	5/8"	8 on 6-1/2"	Four-bolt
689466	8,000 lbs.	Yes	Triple	5/8"	8 on 6-1/2"	Four-bolt
<b>Hybrid Conversion Kits</b>						
688835	5,200 - 8,000 lbs.	No	Tandem	1/2"	8 on 6-1/2"	Five-bolt
688836	5,200 - 8,000 lbs.	No	Triple	1/2"	8 on 6-1/2"	Five-bolt
689156	5,200 - 8,000 lbs.	No	Tandem	9/16"	8 on 6-1/2"	Five-bolt
689159	5,200 - 8,000 lbs.	No	Triple	9/16"	8 on 6-1/2"	Five-bolt
689017	5,200 - 8,000 lbs.	No	Tandem	5/8"	8 on 6-1/2"	Five-bolt
689018	5,200 - 8,000 lbs.	No	Triple	5/8"	8 on 6-1/2"	Five-bolt
689389	5,200 - 8,000 lbs.	Yes	Tandem	5/8"	8 on 6-1/2"	Five-bolt
689391	5,200 - 8,000 lbs.	Yes	Triple	5/8"	8 on 6-1/2"	Five-bolt

# DISC BRAKE ROTOR ASSEMBLIES

- Lippert genuine replacement part
- Grease and oil options
- Durable, cast iron construction
- Backed by a 1-year warranty

Axle Capacity	Bolt Pattern	Wheel Size	Stud Size	Raw Single Grease #	Raw Single Oil #	Raw Bulk Pallet #	Pallet Qty
<b>Standard - Press-In Dust Cap</b>							
6,000 lbs.	6 on 5-1/2"	15" - 16"	1/2"	792640	--	792646	45
7,000 lbs.	8 on 6-1/2"	16"	1/2"	792642	--	792648	45
<b>Standard - Threaded Dust Cap</b>							
8,000 lbs.	8 on 6-1/2"	16" - 17-1/2"	9/16"	792676	792675	792674	45
8,000 lbs.	8 on 6-1/2"	17-1/2"	5/8"	792679	792677	792678	45
10,000 lbs.	8 on 6-1/2"	16" - 17-1/2"	5/8"	2021093228	2020111739	--	--
12,000 lbs.	8 on 6-1/2"	16" - 17-1/2"	5/8"	2021093199	2020111749	--	--
16,000 lbs.	8 on 275 mm	17-1/2"	M22	2021092676	2020111550	--	--

**Raw grease:** includes inner bearing and seal, greased (installed)

**Raw oil:** includes inner bearing and seal (installed)

**Raw bulk pallet:** on a pallet in the specified quantity

**Note:** 6K - 8K includes outer bearing and 10K - 16K does not include outer bearing

# DISC BRAKE CALIPERS

- Lippert genuine replacement part
- Custom caliper bodies designed for easy installation
- Zinc dichromate, anti-corrosion finishes provide rust resistance for iron caliper bodies and brackets
- Rigorous end-of-line inspection and pressure testing ensure quality and performance
- Includes disc brake pads and fittings
- Durable, cast iron construction
- Backed by a 1-year warranty

Axle Capacity	Hub Bolt Pattern	Raw Bulk Pallet #	Pallet Qty
3,500 - 6,000 lbs.	5 on 4-1/2" 6 on 5-1/2"	792625	TBD
7,000 - 8,000 lbs.	8 on 6-1/2"	792626	TBD
10,000 - 16,000 lbs.	8 on 6-1/2" 8 on 275 mm	2020111769	TBD

# DISC BRAKE CALIPER BRACKETS

- Lippert genuine replacement part
- Durable, cast iron construction
- Backed by a 1-year warranty

Axle Capacity	Bolt Pattern	Hub Bolt Pattern	Raw Bulk Pallet #	Pallet Qty
3,500 lbs.	Four-bolt	5 on 4-1/2"	792606	TBD
5,200 - 6,000 lbs.	Five-bolt	6 on 5-1/2"	792607	TBD
7,000 lbs.	Five-bolt	8 on 6-1/2"	792608	TBD
8,000 lbs.	Four-bolt	8 on 6-1/2"	792683	TBD
10,000 - 16,000 lbs.	Seven-bolt	8 on 6-1/2" 8 on 275 mm	792685	TBD

# DISC BRAKE PADS

Part #	Axle Capacity	Includes
2021013448	3,500 - 6,000 lbs.	Four pads
2021013449	7,000 - 8,000 lbs.	Four pads
2021013450	10,000 - 16,000 lbs.	Four pads

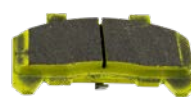

2021013448



2021013449



2021013450

# BEARING KITS & COMPONENTS

Universally compatible with Dexter

- All kits include outer bearing with cotter pin, outer race, inner race, inner bearing and grease seal



2023133982



2023133984

Axle Capacity (lbs.)	Retail Packaged Kit #	Poly Bag Kit #	Kit Components									
			Note: Industry number is for reference only. Do not use this number to order your parts									
			Outer Bearing #	Industry Number	Outer Race #	Industry Number	Inner Race #	Industry Number	Inner Bearing #	Industry Number	Seal #	
2,200	2023133979	--	122089	L44649	125102	L44610	125102	L44610	122089	L44649	139514	
3,500	2023133980	333948	122089	L44649	125102	L44610	124296	L68111	122092	L68149	122087	
5,200	2023133981	333949	122090	LM67048	124292	LM67010	124287	25520	122066	25580	122088	
6,000	2023133982	333950	122091	15123	126996	15245	124287	25520	122066	25580	122088	
7,000	2023133983	333951	127009	14125A	127012	14276	124287	25520	122066	25580	122088	
8,000	2023133984	--	129752	02475	168687	02420	124287	25520	122066	25580	122088	
10,000	2023133985	--	122066	25580	124287	25520	183463	382A	183807	387A	176692	
12,000 - 16,000	2023133986	--	293381	28622	293382	28682	293379	3920	293380	3984	295924	

# GREASE SEALS & UNITIZED OIL SEALS

Universally compatible with Dexter

- Provides protective barrier between the axle hub grease and the outside elements



333960



276712



2023134018

Axle Capacity	Retail Clamshell #	Single #	2-Pack #	10-Pack #	Spindle Shaft Diam.	Hub Bore Diam.
<b>Grease Seals</b>						
1,250 lbs.	--	--	333953	333954	1.25"	1.983"
2,200 lbs.	2023134653	139514	333956	333957	1.5"	1.983"
3,500 - 4,400 lbs.	2023134654	122087	333960	333961	1.719"	2.561"
5,200 - 8,000 lbs.	2023134655	122088	333962	333963	2.25"	3.371"
<b>Unitized Oil Seals</b>						
5,200 - 8,000 lbs.	2023134018	276712	--	--	2.250"	3.371"
10,000 lbs.	2023134019	176692	--	--	2.875"	3.875"
12,000 - 16,000 lbs.	2023134020	295924	--	--	3.125"	4.500"



## PREMIUM AXLE HUB DUST CAPS

- Shields bearings, grease and other inner hub components from dust and contaminants
- Commonly used with hybrid axles
- Oil caps feature an easy, set-screw installation
- Rubber plug included for a complete seal (grease caps)
- O-ring and plug included for a complete seal (oil caps)



85373928



85373929



85373828



85373829

Part #	Axle Capacity	Cap Diam. (A)	Lube	Material	Includes
<b>Threaded Grease Caps</b>					
85373929	8,000 lbs.	2-7/8"	Non-lubed	Die-cast aluminum, smoked lens	Rubber plug, O-ring
85373829	10,000 - 16,000 lbs.	4"	Non-lubed	Die-cast aluminum, smoked lens	Rubber plug, O-ring
<b>Threaded Oil Caps</b>					
695814	8,000 lbs.	2-7/8"	Oil	Plastic, clear lens	Rubber plug, O-ring
693935	10,000 - 16,000 lbs.	4"	Oil	Plastic, clear lens	Rubber plug, O-ring
85373928	8,000 lbs.	2-7/8"	Oil	Die-cast aluminum, clear lens	Rubber plug, O-ring
85373828	10,000 - 16,000 lbs.	4"	Oil	Die-cast aluminum, clear lens	Rubber plug, O-ring

# STANDARD AXLE HUB DUST CAPS & KITS

- Commonly used with standard axles
- Use with rubber plug for a complete seal (included with select models)



Shields bearings, grease and other inner hub components from dust and contaminants

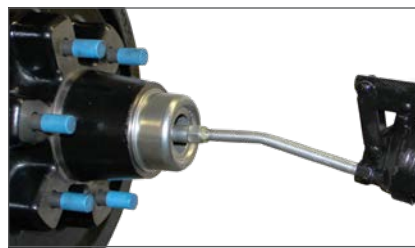

Grease cap with rubber plug allows easy access to grease zerk in axle spindle



Cap diameter

Retail Clamshell #	Single #	10-Pack #	Axle Capacity	Cap Diameter (A)	Lube	Material
2023134658	122099	693794	2,200 - 4,400 lbs.	1.99"	Non-lubed	Zinc-plated steel
2023134661*	122067	693824	2,200 - 4,400 lbs.	1.99"	Super lube	Zinc-plated steel
2023134659	122071	693795	5,200 - 6,000 lbs.	2.45"	Non-lubed	Zinc-plated steel
2023134662*	122064	693749	5,200 - 6,000 lbs.	2.45"	Super lube	Zinc-plated steel
2023134660	127206	--	7,000 - 8,000 lbs.	2.72"	Non-lubed	Zinc-plated steel
2023134011*	127300	693748	7,000 - 8,000 lbs.	2.72"	Super lube	Zinc-plated steel

\* Includes rubber plugs

# UNIVERSAL RUBBER PLUG FOR DUST CAPS

- Seals off dust cap from dirt and debris
- Dust caps sold separately



Retail Clamshell #	Single #	10-Pack #	Bore Size	For Use With	Axle Capacity
2023134012	122065	693722	Universal	Standard lubed dust caps	2,200 - 8,000 lbs.
--	2021027859	--	Universal	Premium lubed dust caps	2,200 - 7,000 lbs.





## SLIPPER SPRINGS

Universally compatible  
with Dexter

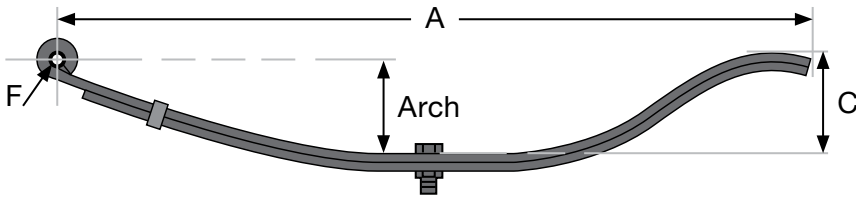

Part #	Spring Capacity	Industry Number*	# of Leaves	Spring Width	Eye-to-End Length (A)	Arch Height Unloaded (C)	Arch Height Loaded (C)	Eye Diam. (F)
132819	1,000 lbs.	72-02	2	1-3/4"	27"	4-3/16"	3-1/8"	9/16"
230281	1,250 lbs.	BT25-12	4	1-3/4"	25"	3-1/2"	2-1/4"	9/16"
157739	1,750 lbs.	BT25-22	3	1-3/4"	25"	3-1/2"	2-1/2"	9/16"
136527	2,000 lbs.	72-30	4	2"	26-7/8"	3"	2"	9/16"
125250	2,500 lbs.	72-31	4	2"	26-7/8"	3-1/16"	2"	9/16"
710493	3,500 lbs.	72-32	5	2"	26-7/8"	3-3/16"	2"	9/16"
342781	3,500 lbs.	E5226	5	2"	26-1/2"	3-1/4"	2-1/2"	9/16"
797547	3,500 lbs.	HW5116	6	2"	26-1/2"	3-1/4"	2"	9/16"
710494	4,000 lbs.	72-33	7	2"	26-7/8"	3-3/16"	2"	9/16"
334744	4,000 lbs.	E5115	6	2"	29-1/2"	3-1/2"	2-1/2"	9/16"
796558	4,000 lbs.	E5226/7	7	2"	26-1/2"	3-1/4"	2"	9/16"
176326	5,000 lbs.	72-80	5	2-1/2"	30-1/2"	4"	2-11/16"	3/4"
296155	6,000 lbs.	72-44	6	3"	30-1/2"	4"	2-3/4"	1"
353498	8,000 lbs.	72-46	6	3"	30-1/2"	4"	2-3/4"	1"
771492	11,200 lbs.	354-00	3	3"	43-3/4"	6-1/4"	5-1/4"	N/A

\* Note: Industry number is for reference only. Do not use this number to order your parts



## DOUBLE-EYE SPRINGS

Universally compatible with Dexter

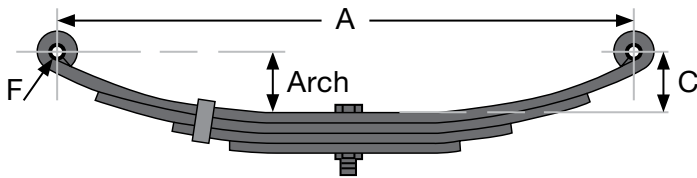

Part #	Spring Capacity	Industry Number*	# of Leaves	Spring Width	Unloaded Eye-to-Eye Length (A)	Loaded Length	Arch Height Unloaded (C)	Arch Height Loaded (C)	Eye Diam. (F)
127094	1,000 lbs.	72-17	3	1-3/4"	20-3/8"	21"	2-7/8"	2-1/8"	9/16"
127103	1,250 lbs.	72-06	3	1-3/4"	23-1/8"	24"	3-1/2"	2-1/2"	9/16"
125215	1,750 lbs.	72-09	3	1-3/4"	23-3/16"	24"	3-1/2"	2-1/2"	9/16"
125799	2,000 lbs.	72-18	3	1-3/4"	23-1/8"	24"	3-1/2"	2-1/2"	9/16"
125797	2,000 lbs.	72-24	3	1-3/4"	25-1/4"	26"	3"	1-3/4"	9/16"
125269	1,400 lbs.	72-13	4	1-3/4"	20-1/2"	21"	3-1/2"	2-3/8"	9/16"
124903	1,750 lbs.	72-42	4	1-3/4"	25-1/2"	26"	3"	1-1/2"	9/16"
702096	3,000 lbs.	72-26	4	1-3/4"	25-1/4"	26"	3-1/8"	1-3/4"	9/16"
129745	2,200 lbs.	72-78	4	1-3/4"	25-1/4"	26"	3-1/8"	2"	9/16"
133982	2,500 lbs.	72-20	4	1-3/4"	23-1/8"	24"	3-1/2"	2-1/2"	9/16"
702095	2,600 lbs.	72-97	4	1-3/4"	25-1/4"	26"	3-1/8"	1-3/4"	9/16"
334743	3,000 lbs.	SW-5	5	1-3/4"	25-1/4"	26"	3-1/8"	1-3/4"	9/16"
679372	3,500 lbs.	72-98	6	1-3/4"	24-7/8"	26"	3-1/4"	1-3/4"	9/16"
2021095282	4,000 lbs.	72-100	7	1-3/4"	24-7/8"	26"	3-1/4"	1-3/4"	9/16"

\* Note: Industry number is for reference only. Do not use this number to order your parts

# AXLE AP SUSPENSION KITS

- Helps bolt axle leaf springs to the hangers



121101

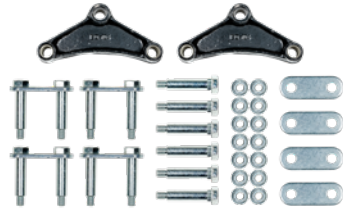

121097



121100



128877



169381



184173

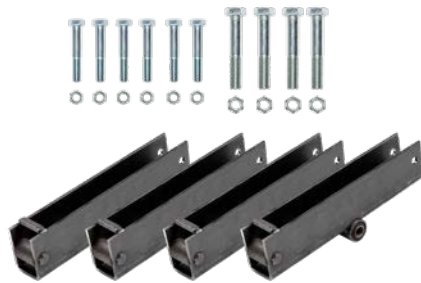

184176

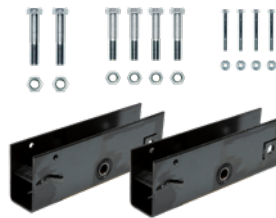

302934

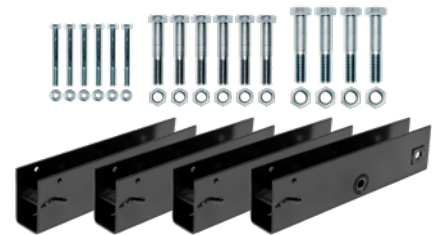

321436

Part #	Axle Capacity	Industry Number*	Number of Axles	Spring Width	Axle Spacing
121101	2,200 - 8,000 lbs.	--	1	1-3/4"	--
156767	2,200 - 8,000 lbs.	--	2	1-3/4"	33" or 35"
121097	2,200 - 8,000 lbs.	EQ-104	2	1-3/4"	33"
121098	2,200 - 8,000 lbs.	EQ-310	2	1-3/4"	33"
121099	2,200 - 8,000 lbs.	EQ-E1	2	1-3/4"	35"
121100	2,200 - 8,000 lbs.	EQ-104 & 105	3	1-3/4"	33"
132698	2,200 - 8,000 lbs.	EQ-1 & 13-126	3	1-3/4"	35"
128877	3,500 - 8,000 lbs.	EQ-13-4	2	2"	33-1/2"
137383	3,500 - 8,000 lbs.	EQ-13-4	3	2"	33-1/2"
165268	3,500 - 8,000 lbs.	EQ-13-44	2	2"	36"
169381	3,500 - 8,000 lbs.	EQ-13-44	3	2"	36"
184173	10,000 lbs.	--	2	2-1/2"	42 1/4"
184174	10,000 lbs.	--	3	2-1/2"	42 1/4"
184175	10,000 lbs.	--	2	2-1/2"	48 1/2"
184176	10,000 lbs.	--	3	2-1/2"	48 1/2"
302934	12,000 - 16,000 lbs.	--	2	3"	42 1/4"
321435	12,000 - 16,000 lbs.	--	3	3"	42 1/4"
302964	12,000 - 16,000 lbs.	--	2	3"	48 1/2"
321436	12,000 - 16,000 lbs.	--	3	3"	48 1/2"

\* Note: Industry number is for reference only. Do not use this number to order your parts

# AXLE EQUALIZERS

- Equalizer connector allows for enough movement between the axles to keep the ride smooth and the load undisturbed
- For use with double-eye springs
- Includes nylon bushings

## How to measure different equalizer styles

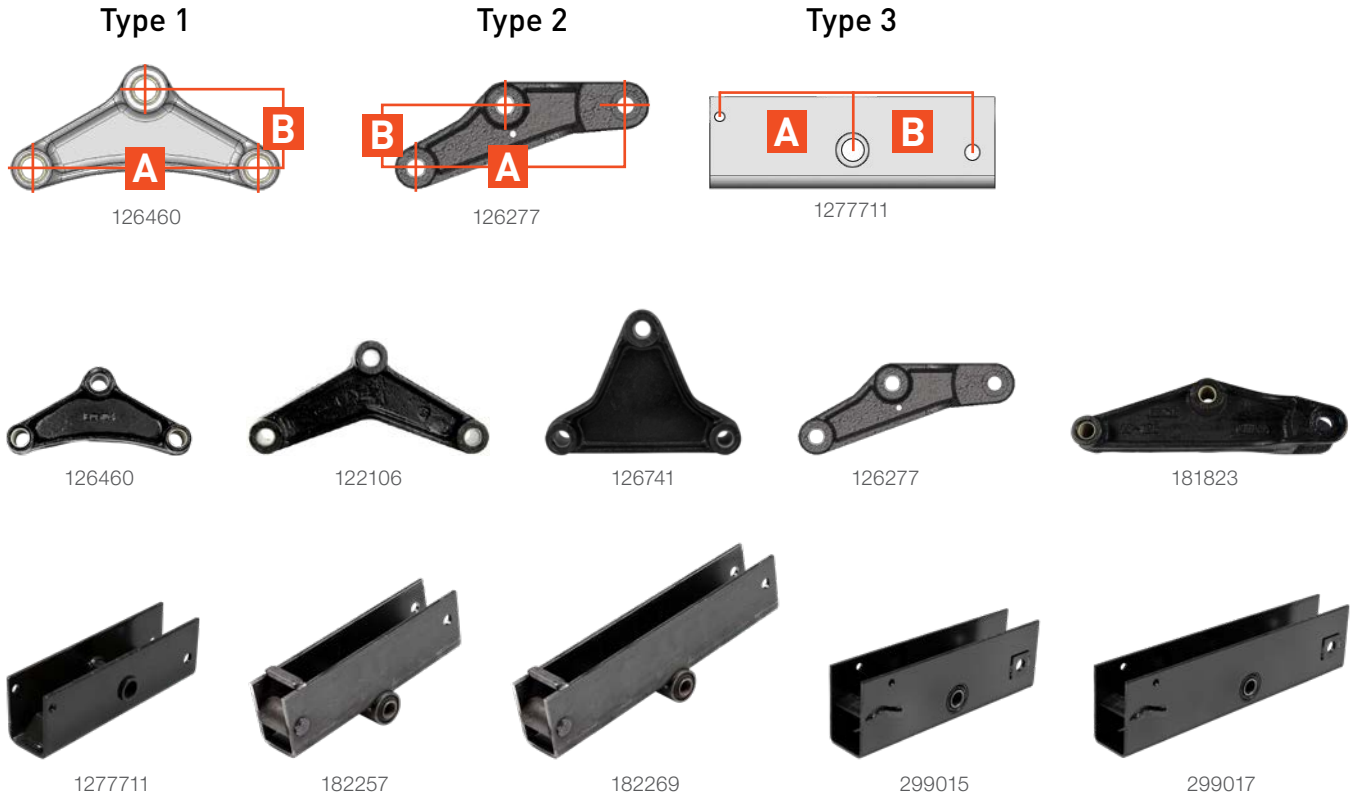

Part #	Industry Number*	Number of Axles	Spring Width	Axle Spacing	Type	A (Width)	B (Height)
126460	EQ-104	2	1-3/4"	33"	1	5-3/4"	2"
122106	EQ-E1	2	1-3/4"	35"	1	7-3/4"	2-7/8"
126741	EQ-310	2	1-3/4"	33"	1	6-1/16"	4"
126277	EQ-105	3	1-3/4"	33"	2	6-3/4"	2"
181823	EQ-126	3	1-3/4"	35"	2	8-11/16"	2-1/2"
1277711	EQ-1304	2 / 3	2"	33-1/2"	3	5-1/8"	4-5/8"
182257	--	2 / 3	2-1/2"	42-1/4"	3	6-7/8"	6-11/16"
182269	--	2 / 3	2-1/2"	48-1/2"	3	9-9/16"	9-9/16"
299015	--	2 / 3	3"	42-1/4"	3	7"	7-1/8"
299017	--	2 / 3	3"	48-1/2"	3	10-3/4"	10-1/4"

\* Note: Industry number is for reference only. Do not use this number to order your parts

# SHACKLE LINKS & ASSEMBLIES

- Connects suspension springs and axle hangers
- Typically used with greaseable wet bolts
- Zinc-plated construction



122487



133207



126172



1567651



125675



133485

Part #	Includes	Shackle Thickness	Center-to-Center
122487	One shackle link	0.224"	2-1/4"
133207	One shackle link	0.224"	3-1/8"
125675	One shackle link, two shoulder bolts	0.224"	2-1/4"
133485	One shackle link, two shoulder bolts	0.224"	3-1/8"
126172	One heavy-duty shackle link	1/2"	2-1/4"
1567651	One heavy-duty shackle link	1/2"	3-1/8"
126205	One heavy-duty shackle link, two shoulder bolts	1/2"	2-1/4"
156766	One heavy-duty shackle link, two shoulder bolts	1/2"	3-1/8"

# AXLE U-BOLT MOUNTING KITS

- Includes four U-bolts, two tie-plates and eight nuts



297426



297427



297429

Part #	Axle Capacity	Fits Axle Tube Size	Length	Thread End
297426	2,200 lbs.	1-3/4"	4-3/8"	3/8"-24
297427	3,500 lbs.	2-3/8"	5-1/8"	1/2"-20
297429	4,400 lbs.	3"	6-1/2"	1/2"-20

# AXLE U-BOLTS

- Yellow zinc-plated finish resists rust and corrosion



Part #	Axle Capacity	Fits Axle Tube Size	Length	Thread End	Suggested Nut #
2013251	2,200 lbs.	1-3/4"	4-3/8"	3/8"-24	139725
122073	3,500 lbs.	2-3/8"	5-1/8"	1/2"-20	122079
122070	4,400 lbs.	3"	6-1/2"	1/2"-20	122079
2139541	7,000 lbs.	3"	6-5/8"	9/16"-18	2020221022
1963511	8,000 lbs.	3"	7-1/4"	9/16"-18	2020221022
1819261	10,000 lbs.	4"	8-3/4"	5/8"-11	142833
2961681	10,000 - 16,000 lbs.	5"	10"	5/8"-11	142833

# AXLE HANGERS

- Axle hangers are welded to the chassis to allow mounting of axles and axle components



Part #	Axle Capacity	Location	To Hole (A)	Length (B)	Width (C)	Hole Size (D)
106181	2,200 - 8,000 lbs.	--	1-1/4"	1-15/16"	2"	9/16"
106182	2,200 - 8,000 lbs.	--	2-1/4"	2-15/16"	2"	9/16"
106183	2,200 - 8,000 lbs.	--	3-1/4"	3-1/16"	2"	9/16"
106185	2,200 - 8,000 lbs.	--	4-1/4"	4-15/16"	2"	9/16"
106184	2,200 - 8,000 lbs.	--	5"	5-5/8"	2"	9/16"
102906	2,200 - 8,000 lbs.	--	3" (A) / 5" (A1)	5"	2"	9/16"
127784	2,200 - 8,000 lbs.	Front	3-9/16"	4-5/16"	2-3/16"	9/16"
127783	2,200 - 8,000 lbs.	Rear	4"	6"	2-1/4"	5/16"
127782	2,200 - 8,000 lbs.	Center	3-5/16"	4-1/2"	3-1/8"	7/8"
182242	10,000 lbs.	Front	5-1/2"	8"	2-3/4"	3/4"
182245	10,000 lbs.	Rear	6-1/8"	8"	2-3/4"	--
184079	10,000 lbs.	Center	1-7/8"	3-1/4"	4-1/8"	1"
298462	12,000 - 16,000 lbs.	Front	6-1/4"	7-1/2"	3-1/8"	1"
298458	12,000 - 16,000 lbs.	Center	4-1/8"	5-5/8"	3-7/8"	1-1/8"
298553	12,000 - 16,000 lbs.	Rear	6-5/8"	8-1/2"	3-1/8"	1/2"

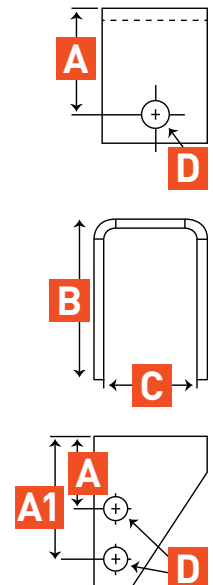

# SPINDLE WASHERS



Part #	Axle Capacity	Style	Inside Diameter	Outside Diameter
122086	2,200 - 4,400 lbs.	Lock	7/16"	3/4"
119214	2,200 - 5,200 lbs.	Round	1"	1-11/16"
119215	2,200 - 7,000 lbs.	D-flat	1"	1-11/16"
119216	2,200 - 7,000 lbs.	Locking tang	1"	1-11/16"
179660	6,000 - 8,000 lbs.	Round	1-1/16"	2"
162838	8,000 lbs.	Lock	1/2"	7/8"
181895	10,000 lbs.	Round	1-1/2"	3"
358550	12,000 - 16,000 lbs.	Round	1-7/8"	3-3/8"

# AXLE BOLTS



Retail Clamshell #	Clamshell Quantity	Single #	Type	Diameter	Shoulder Length	Thread End	Suggested Nut #
--	--	122102	Shoulder bolt	9/16"	2-5/16"	7/16"-20	122103
--	--	271254	Shoulder bolt	9/16"	2-13/16"	7/16"-20	122103
--	--	126238	Wet bolt	9/16"	2-5/16"	7/16"-20	122103
--	--	126197	Wet bolt	9/16"	2-13/16"	7/16"-20	122103
2023134013	6	121803	Wheel bolt	0.617" knurl	2"	1/2"-20	122076
--	--	181677	Wheel bolt	0.545" knurl	2"	1/2"-20	122076
2023134014	4	132624	Wheel bolt	0.617" knurl	2-5/16"	9/16"-18	134581
Coming soon	--	175704	Wheel bolt	0.689" knurl	2-5/16"	9/16"-18	134581
Coming soon	--	175705	Wheel bolt	0.689" knurl	2-3/4"	5/8"-18	176321 or 723971
Coming soon	--	183128	Wheel bolt	0.689" knurl	3-7/16"	5/8"-18	176321 or 723971
Coming soon	--	352774	Wheel bolt	1.007" knurl	4-13/16"	M22 x 1.5	352303
--	--	183536	Hex bolt	--	1-1/2"	1/2"-13	N/A
--	--	162836	Hex bolt	--	1-1/2"	1/2"-20	122253
--	--	207576	Hex bolt	--	1-1/2"	7/16"-20	N/A

# AXLE NUTS



122085



139725



122079



2020221022



176321



122077



122103



122081



181894



330037



122076



134581



723971



352303

Retail Clam #	Qty	Bulk #	Type	Thread End
--	--	122085	Hex	7/16"-20
--	--	122253	Hex	1/2"-20
--	--	139725	Hex flange	3/8"-24
--	--	122079	Hex flange	1/2"-20
--	--	2020221022	Hex flange	9/16"-18
2024039634	8	176321	Hex flange	5/8"-18
--	--	122077	Hex lock	3/8"-24
--	--	122103	Hex flange lock	7/16"-20
2024039632	6	122076	60° cone wheel	1/2"-20

Retail Clam #	Qty	Bulk #	Type	Thread End
2024039633	8	134581	60° cone wheel	9/16"-18
--	--	122081	Six-slot spindle	1"-14
--	--	181894	Six-slot spindle	1-1/2" - 12
--	--	330037	Six-slot spindle	1-3/4" - 12
2024039635	8	723971	Swiveling flange	5/8"-18
--	--	352303	Swiveling flange	M22 x 1.5

# AXLE & LUG NUT KITS



2023134656



2023134657



2023134021



2023134022

Retail Clamshell #	Nut #	Washer #	Cotter Pin #	Thread End
2023134656	122081	119214	122075	1"-14
2023134657	122081	119215 / 119216	--	1"-14
2023134021	181894	181895	181899	1-1/2" - 12
2023134022	330037	358550	181899	1-3/4" - 12



## WIRE CONNECTOR

- Sealed wire connector for axles with electric brakes
- Includes one wire connector



122084

Part #	Fits
122084	All electric brake lead wires 20-12 gauge wires

## COTTER PIN

- Cotter pin should be replaced every time the hub is disassembled after use
- Standard sizes fit most applications



122075



181899

Part #	Axle Capacity	Diameter	Length
122075	Up to 8,000 lbs.	1/8"	1-3/4"
181899	10,000 - 16,000 lbs.	1/4"	2-1/4"

## GREASE ZERK

- Allows for easy lubrication of wet bolt equalizers and lubricated axles
- Includes one grease zerk



122255

Part #	For
122255	Super-Lube axle spindles

## BRONZE LEAF SPRING BUSHING

- Standard for most Lippert axle hanger attaching part kits
- Compatible with most leaf spring eyes



126171

Part #	Inside Diam.	Outside Diam.	Length
126171	0.58"	0.70"	1.74"

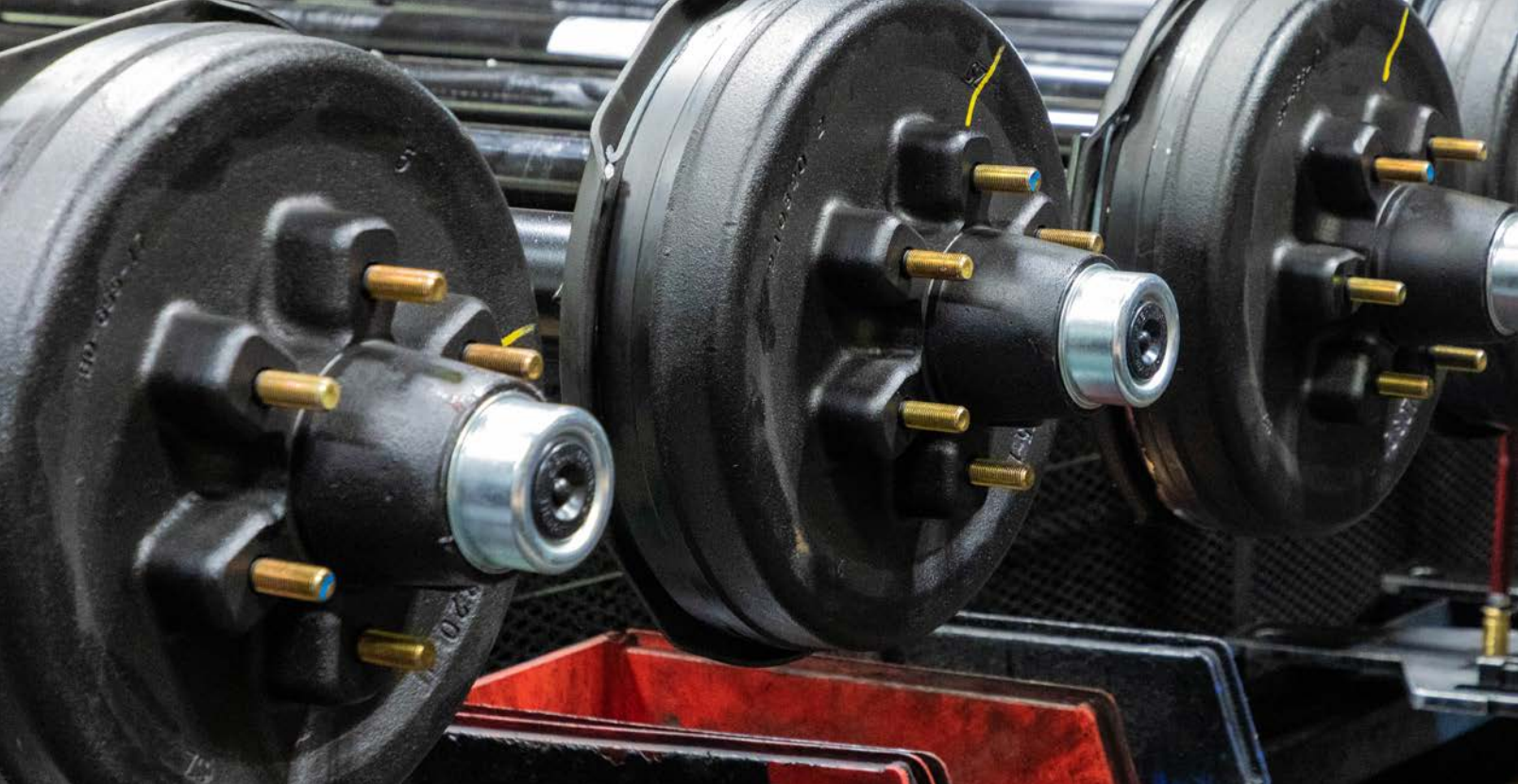

# AXLE BREAKDOWNS BY CAPACITY

## 2.2K 2,200 LB. WHEEL END REPLACEMENT PARTS

For replacement parts and upgrades, see pages 8 - 30

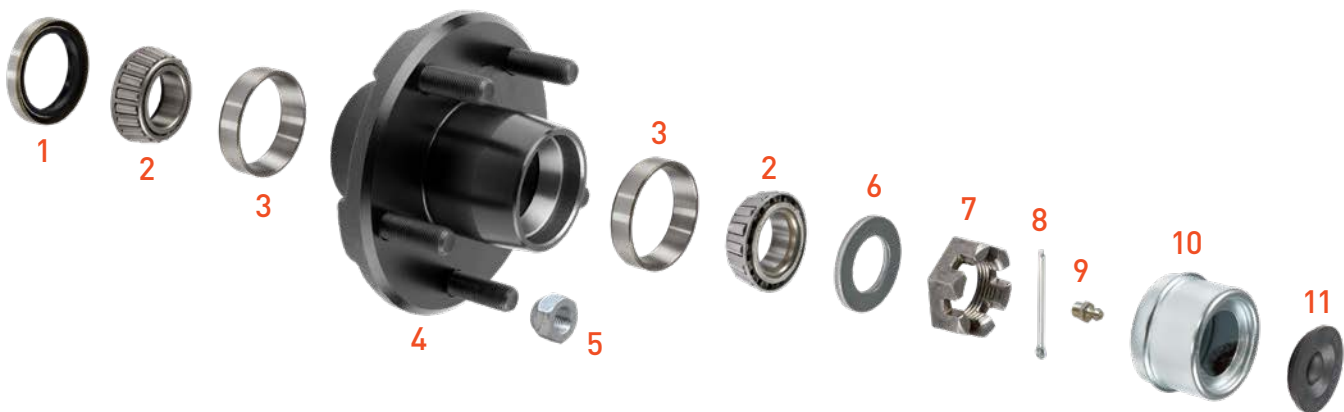

### Standard parts

Item #	Part #	Description
1	139514	Grease seal (1.50" ID)
2	122089	Inner / outer bearing cone (L44649)
3	125102	Inner / outer bearing cup (L44610)
4	134332	Idler hub with studs (5 on 4-1/2") with 5-1/2" flange
5	122076	60° cone wheel nut (1/2"-20)

Item #	Part #	Description
6	119214	Spindle washer, round
7	122081	Six-slot spindle nut (1"-14)
8	122075	Cotter pin
9	122255	Grease zerk, lubed
10	122067	Lubed dust cap
11	122065	Dust cap rubber plug

# 3.5K 3,500 LB. WHEEL END REPLACEMENT PARTS

For replacement parts and upgrades, see pages 8 - 30



## Standard parts

Item #	Part #	Description
1	122450	Elec. brake assembly, right (10" x 2-1/4")
1.1	122258	Elec. brake assembly, left (10" x 2-1/4")
1.2*	346566	Elec. brake assembly, right (10" x 2-1/4")
1.3*	3465661	Elec. brake assembly, left (10" x 2-1/4")
2	122087	Grease seal, double-lip (1.72" ID)
3	122092	Inner bearing cone (L68149)
4	124296	Inner bearing cup (L68111)
5	126003	Hub drum with studs (5 on 4-1/2")
6	122076	60° cone wheel nut (1/2"-20)

Item #	Part #	Description
7	125102	Outer bearing cup (L44610)
8	122089	Outer bearing cone (L44649)
9	119214	Spindle washer, round
10	122081	Six-slot spindle nut (1"-14)
11	122075	Cotter pin
12	122255	Grease zerk, lubed
13	122067	Lubed dust cap
14	122065	Dust cap rubber plug

\* To convert to 4,400 lb. axle, use these brake numbers

# 5.2K 5,200 LB. WHEEL END

For replacement parts and upgrades, see pages 8 - 30



## Standard parts

Item #	Part #	Description
1	122451	Electric brake assembly, right (12" x 2")
1.1	122259	Electric brake assembly, left (12" x 2")
2	122088	Grease seal, double-lip (2.25" ID)
3	122066	Inner bearing cone (25580)
4	124287	Inner bearing cup (25520)
5	122094	Hub drum with studs (6 on 5-1/2")
6	122076	60° cone wheel nut (1/2"-20)

Item #	Part #	Description
7	124292	Outer bearing cup (LM67010)
8	122090	Outer bearing cone (LM67048)
9	119214	Spindle washer, round
10	122081	Six-slot spindle nut (1"-14)
11	122075	Cotter pin
12	122255	Grease zerk, lubed
13	122064	Lubed dust cap
14	122065	Dust cap rubber plug

**6K****6,000 LB.  
WHEEL END**For replacement parts and  
upgrades, see pages 8 - 30**Standard parts**

Item #	Part #	Description
1	122451	Electric brake assembly, right (12" x 2")
1.1	122259	Electric brake assembly, left (12" x 2")
2	122088	Grease seal, double-lip (2.25" ID)
3	122066	Inner bearing cone (25580)
4	124287	Inner bearing cup (25520)
5	122094	Hub drum with studs (6 on 5-1/2")
6	122076	60° cone wheel nut (1/2"-20)

Item #	Part #	Description
7	126996	Outer bearing cup (15245)
8	122091	Outer bearing cone (15123)
9	179660	Spindle washer, round
10	122081	Six-slot spindle nut (1"-14)
11	122075	Cotter pin
12	122255	Grease zerk, lubed
13	122064	Lubed dust cap
14	122065	Dust cap rubber plug



**Standard parts**

Item #	Part #	Description
1	122451	Electric brake assembly, right (12" x 2")
1.1	122259	Electric brake assembly, left (12" x 2")
2	122088	Grease seal, double-lip (2.25" ID)
3	122066	Inner bearing cone (25580)
4	124287	Inner bearing cup (25520)
5	122096	Hub drum with studs (8 on 6-1/2")
6	122076	60° cone wheel nut (1/2"-20)

Item #	Part #	Description
7	127012	Outer bearing cup (14276)
8	127009	Outer bearing cone (14125A)
9	179660	Spindle washer, round
10	122081	Six-slot spindle nut (1"-14)
11	122075	Cotter pin
12	122255	Grease zerk, lubed
13	127300	Lubed dust cap
14	122065	Dust cap rubber plug

**8K****8,000 LB.  
WHEEL END**For replacement parts and  
upgrades, see pages 8 - 30**Standard parts**

Item #	Part #	Description
Not shown	2022004550	Electric brake assembly, right (12-1/4" x 3-3/8")
Not shown	2022004549	Electric brake assembly, left (12-1/4" x 3-3/8")
1	276712	Unitized oil seal (2.226" ID)
2	122066	Inner bearing cone (25580)
3	124287	Inner bearing cup (25520)
4	2772121	Hub drum with 5/8 studs (8 on 6-1/2")
5	176321	Flange wheel nut (5/8"-18)

Item #	Part #	Description
6	168687	Outer bearing cup (02420)
7	129752	Outer bearing cone (02475)
8	179660	Spindle washer, round
9	122081	Six-slot spindle nut (1"-14)
10	122075	Cotter pin
11	122255	Grease zerk, lubed
12	85373928	Aluminum oil cap

# 8K 8,000 LB. HYBRID WHEEL END

For replacement parts and upgrades, see pages 8 - 30



## Standard parts

Item #	Part #	Description
1	122451	Electric brake assembly, right (12" x 2")
1.1	122259	Electric brake assembly, left (12" x 2")
2	276712	Unitized oil seal (2.226" ID)
3	122066	Inner bearing cone (25580)
4	124287	Inner bearing cup (25520)
5	347627	Hub drum with 5/8 studs (8 on 6-1/2")
6	176321	Flange wheel nut (5/8"-18)

Item #	Part #	Description
7	168687	Outer bearing cup (02420)
8	129752	Outer bearing cone (02475)
9	179660	Spindle washer, round
10	122081	Six-slot spindle nut (1"-14)
11	122075	Cotter pin
12	122255	Grease zerk, lubed
13	85373928	Aluminum oil cap



**10K****10,000 LB. SHORT  
WHEEL END**For replacement parts and  
upgrades, see pages 8 - 30**Standard parts**

Item #	Part #	Description
Not shown	181936	Electric brake assembly, right (12-1/4" x 3-3/8")
Not shown	181935	Electric brake assembly, left (12-1/4" x 3-3/8")
1	176692	Unitized oil seal (2.875" ID)
2	183807	Inner bearing cone (387A)
3	183463	Inner bearing cup (382A)
4	791399	Hub drum with 5/8 studs (8 on 6-1/2")

Item #	Part #	Description
5	176321	Flange wheel nut (5/8"-18)
6	124287	Outer bearing cup (25520)
7	122066	Outer bearing cone (25580)
8	181895	Spindle washer
9	181894	Spindle nut (1-1/2"-12)
10	181899	Cotter pin
11	85373829	Aluminum grease cap

**12K****12,000 LB.  
WHEEL END**For replacement parts and  
upgrades, see pages 8 - 30**Standard parts**

Item #	Part #	Description
Not shown	2979981	Electric brake assembly, right (12-1/4" x 5")
Not shown	297998	Electric brake assembly, left (12-1/4" x 5")
1	295924	Unitized oil seal (3.125 ID)
2	293380	Inner bearing cone (3984)
3	293379	Inner bearing cup (3920)
4	297983	Hub drum with 5/8 studs (8 on 6-1/2")

Item #	Part #	Description
5	176321	Flange wheel nut (5/8"-18)
6	293381	Outer bearing cup (28622)
7	293382	Outer bearing cone (28682)
8	358550	Spindle washer (1-3/4")
9	330037	Spindle nut (1-3/4")
10	181899	Cotter pin
11	85373828	Aluminum oil cap

**16K****16,000 LB.  
WHEEL END**For replacement parts and  
upgrades, see pages 8 - 30**Standard parts**

Item #	Part #	Description
Not shown	2979981	Electric brake assembly, right (12-1/4" x 5")
Not shown	297998	Electric brake assembly, left (12-1/4" x 5")
1	295924	Unitized oil seal (3.125 ID)
2	293380	Inner bearing cone (3984)
3	293379	Inner bearing cup (3920)
4	353323	Hub drum with M22 studs (8 on 275mm)

Item #	Part #	Description
5	352303	Wheel nut, M22
6	293381	Outer bearing cup (28622)
7	293382	Outer bearing cone (28682)
8	358550	Spindle washer (1-3/4")
9	330037	Spindle nut (1-3/4")
10	181899	Cotter pin
11	85373828	Aluminum oil cap



## SHOCK ASSEMBLIES

- Bolt-on shock kit absorbs road shock to provide a more comfortable towing experience
- Kit comes with everything needed to attach gas shocks to an existing trailer suspension
- Single replacement shocks are also available



281281



281255



283280



283271

Part #	Includes	Fits	Compressed Length	Extended Length
281255	Two shock assemblies, four U-bolts, two shock mount assemblies, two tie plates, eight washers, hex nuts and hex bolts	2-3/8" axles tubes	8-5/8"	13-1/2"
281281	Two shock assemblies, four U-bolts, two shock mount assemblies, two tie plates, eight washers, hex nuts and hex bolts	3" axles tubes	8-5/8"	13-1/2"
283280	One heavy-duty yellow shock, four top plates, four rubber bushings, two nuts	All axle tube sizes	8-5/8"	13-1/2"
283271	One standard black shock, four top plates, four rubber bushings, two nuts	All axle tube sizes	7-1/2"	12"



## ROAD ARMOR™ SHOCK-ABSORBING TRAILER EQUALIZER KIT

- Using anti-shock technology, road shock and vibrations are dampened, resulting in less chucking and less strain on the trailer
- Offers trailer owners a superior suspension enhancement
- Exceptional substitution for torsion axles
- Single pivoting arm allows constant absorption and dampened road shock from the leading or trailing spring, utilizing the trailer's natural motion
- Upgraded spray-coating on all fasteners to match automotive specifications
- Mounting hardware sold separately
- Patent pending



2021015191



Engineered to obtain maximum absorption with its anti-shock technology



Greaseable bronze bushings improve wear and tear

Part #	Axle Configuration	Axle Capacity	Includes
2021015191	Tandem	3,500 lbs. - 8,000 lbs.	Two tandem equalizers, greaseable bronze bushings and fasteners

# EQUA-FLEX® RUBBERIZED EQUALIZER

- Dramatically reduces fore to aft trailer movement, otherwise known as chucking
- Helps eliminate trailer and cargo damage caused by road shock and vibration
- Delivers a ride as smooth as torsion axles at a fraction of the cost
- Includes pre-installed bronze bushings
- Center hanger and other mounting hardware sold separately



314336



279688



279687



281314



279689

## Standard

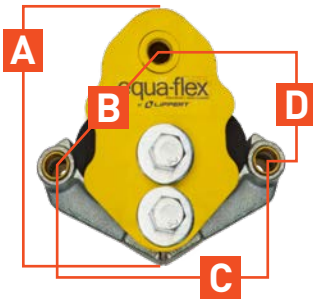

## Wide stance

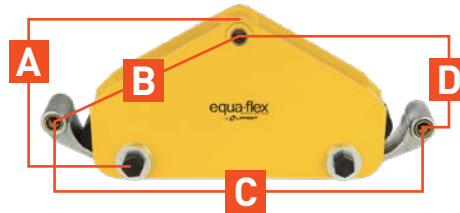

## Heavy-duty

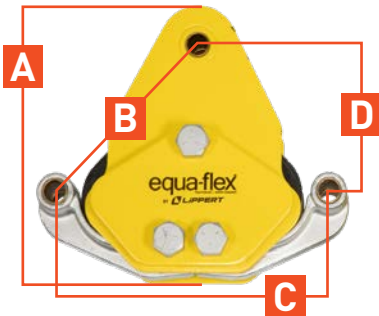

Helps eliminate trailer and cargo damage caused by road shock and vibration

Part #	Axle Configuration	A	B	C	D	E	Axle Capacity
279687	Tandem	6"	4-1/8"	5-1/2"	2-7/8"	--	4,000 lbs. - 6,000 lbs.
279688	Tandem, heavy-duty	7-1/4"	5-1/2"	7-1/4"	3-5/8"	--	6,000 lbs. - 8,000 lbs.
314336	Tandem, wide stance	6-1/2"	8-1/4"	14-5/8"	1-7/8"	--	3,500 lbs. - 5,200 lbs.
281314	Triple	6"	4-1/8"	5-1/2"	2-7/8"	6-3/4"	3,000 lbs. - 6,000 lbs.
279689	Triple, heavy-duty	7-1/4"	5-1/2"	7-1/4"	3-5/8"	8-3/8"	5,000 lbs. - 8,000 lbs.
145547	Triple, heavy-duty	7-1/4"	5-1/2"	7-1/4"	3-5/8"	7-1/2"	5,000 lbs. - 8,000 lbs.



## SLIPPER ROLLER SUSPENSION

- Maintenance-free slipper spring suspension technology eliminates wear components
- Axles remain parallel while negotiating uneven roads and side-to-side weight differences
- Reduced bump steer and tire wear
- Improved fuel efficiency
- Reduced operating noise
- Quick installation due to reduced bolted joints and no shackle link or hanger bolt assembly
- 2" wide slipper spring reduces stress on the system by 15 to 20% for improved durability and safety
- Available in a wider stance to improve towing stability
- Self-adjusting brakes for improved stopping ability and reduced maintenance
- Includes black powder-coated springs, axle tube and tie-plates, along with dichromate hardware for superior corrosion resistance
- VALCRUM universal aluminum hub caps are available for 6K, 7K and 8K axles capacities only

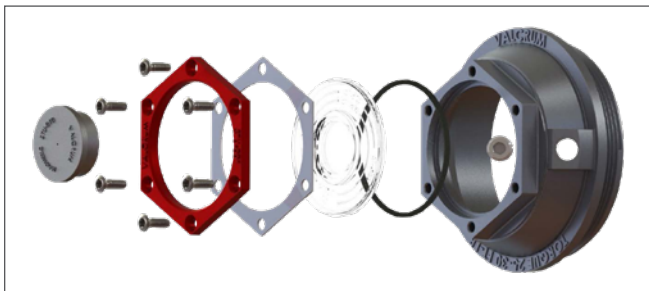

VALCRUM universal aluminum hub caps offer a superior upgrade over their plastic counterparts. The aluminum alloy provides better heat dissipation and thermal management. Each cap also features a fill / drain grease port, a magnetic vent plug and machined threads

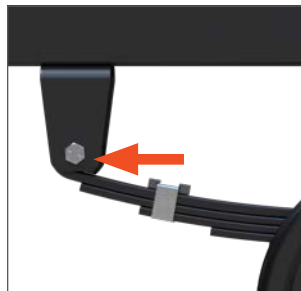

Rubber bushed spring eyes and equalizer to protect unit from vibration, also eliminates all maintenance and wear

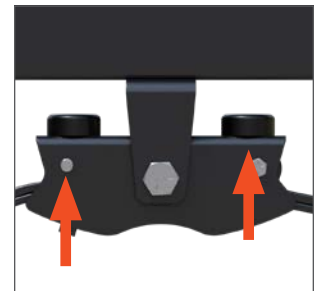

Bump stops on equalizer to prevent over-rotation and high impact loads to frame





# INDEPENDENT SUSPENSION ADVENTURE EDITION

- Independent, adaptive suspension with cushioned, road dampening technology
- Increased suspension travel elicits a reduced spring rate compared to other suspensions resulting in a smoother ride
- Axle-free design provides greater ground clearance for any terrain
- Additional clearance between suspension and tires
- Self-adjusting electric drum brakes minimize servicing
- Practical suspension design with a sub-frame that mounts to the chassis with six attaching fasteners
- Durable powder coat finish for enhanced corrosion resistance
- Toe and camber adjustment system for tire alignment and precise adjustment
- Elegant design for an enhanced aesthetic appeal
- Available in 3,500, 4,870 and 5,200 lb. capacities and straight or 4" drop spindle options
- Available in single and tandem configurations and with anti-lock brake system technology

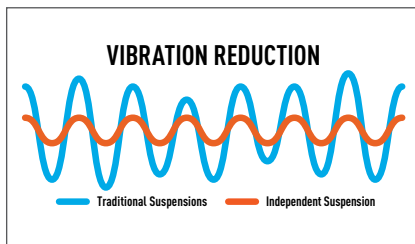

Suspension system reduces rattling and vibration for a more comfortable ride



Gas shocks dampen spring oscillations for improved ride quality and vehicle handling



Coil spring with bump stops to prevent harsh 'bottoming out'

## Available in single or tandem configurations



# INDEPENDENT SUSPENSION TOURING EDITION

- Proprietary dampening and road isolation technology protects your investment from road shock and vibration
- Suspension system reduces rattling and vibration for a more comfortable ride
- Provides nearly two times more articulation compared to a leaf spring suspension
- Ideal suspension to combat everyday potholes, rough highways and roads
- Improved design extends longevity compared to leaf springs
- Track bar design stabilizes the axles and suspension and reduces chassis movement during extreme turn situations
- Durable powder coat finish for enhanced corrosion resistance
- Weight capacities up to 5,200 lbs. (Touring) and 8,000 lbs. (Touring HD) per axle
- Available in single and tandem configurations and with anti-lock brake system technology

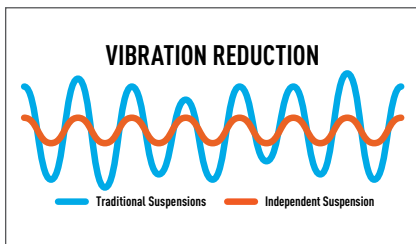

Suspension system reduces rattling and vibration for a more comfortable ride



Robustly designed with 50% fewer fasteners means reduced need for service



Trailing arm style suspension with coil springs and shock absorbers

Available in single or tandem configurations





With anti-lock braking system



Without anti-lock braking system

## ANTI-LOCK BRAKING SYSTEM

- Promotes exceptional towing safety and driver confidence
- Improves control on slippery roads and in emergency braking situations
- Integrates with trailer brakes to prevent trailer wheel lock-up
- Ready to connect to the OneControl® app and Compass Connect
- App provides digital odometer, system monitoring and more
- Works with electromagnetic drum brakes (7-way wiring connector required)
- Fully compatible with or without OEM or aftermarket brake controllers
- Non-intrusive system will not interfere with trailer gain settings



2021017577

Part #	Wheels	Axles	Includes
2021017577	2 to 6	1 to 3	Anti-lock brake system and all required wiring harnesses for installation



## TIRE LINC® AUTO TRAILER TEMPERATURE & PRESSURE MONITORING SYSTEM

- Actively monitors tire pressures and temperatures in real-time
- Provides push notifications when hazardous conditions occur to prevent blowouts
- Connects wirelessly through your smartphone via Bluetooth connection
- Includes rechargeable lithium-powered battery for up to 60 hours of active use
- Automatically enters low-power mode when not in motion to preserve battery
- Easy, do-it-yourself installation (can be permanently wired with provided splice-in wiring harness)
- IP67-rated construction is dustproof and waterproof up to one meter
- Portable design allows use with multiple trailers
- Sensors come with replaceable CR1632 batteries

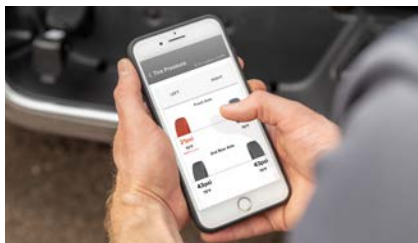

Tire Linc technology integrates with the CURT OneControl® app and provides real-time notifications to your smartphone



Monitors up to 20 tires simultaneously, making it the ideal solution for travel trailers, boat trailers and agricultural or utility trailers



Advanced repeater technology ensures your smartphone always has current information with a strong connection while on the road

Retail Box #	Description	Wheels	Includes
57009	Tire Linc kit	Up to 4	Repeater, four sensors, installation hardware
57011	Tire Linc sensors	Adds 2	Two sensors

# FURRION® VISION S® VEHICLE OBSERVATION SYSTEMS

## Cameras

- Reliable digital connection (2.4GHz)
- 720 x 480 high resolution cameras
- Wide viewing angle with up to four cameras displayed
- Night vision and intelligent IR cut filter for clear viewing
- Motion detection and microphone promotes safety
- Security camera auto-wake with motion detection
- IP65 waterproof rated cameras for durability
- HD monitor with anti-glare display
- Wireless cameras are easy to set up
- Rear assist marker lines to align your vehicle



Increases visibility while backing the vehicle into a parking space or campsite



360-degree views while driving so you can see all around you on the road



Reliable, wireless communication with no lag between camera and monitor

## Monitors

- HD monitor with anti-glare display allows you to toggle between cameras
- Toggle between multiple camera views on the touchscreen monitor
- Low-profile design promotes an unobstructed view out of the windshield



Displays a clear image for up to four cameras for all-around coverage



Reliable, wireless communication with no lag between camera and monitor



Windshield mount provides a solid mounting point for the monitor and allows pivoting

## Camera Systems

- All systems include a camera aux power cord, monitor power cord and windshield mount and come in a full color retail box
- All systems with a rear / doorway security camera include the a camera bracket and gasket
- 5" and 7" monitor systems include a table stand



2021123624



2021123791



2021123914



2021123791



2021123881



2021123887



2021123903



2021123576



2021123862



2021123882 (not LED)



2021123890



2021123904 (LED)



2021123885

Part #	Model #	# of Cameras	LED Marker Lights	Rear Camera (Doorway Security)	Rear Camera with Red Marker Light	Side Camera Pair with Amber Marker Lights
<b>Camera Only</b>						
2021123624	FCN48TASF	1	No	✓	✗	✗
2021123791	FCE48TASH	1	Yes	✗	✗	✓
<b>4.3" Monitor Camera Systems</b>						
2021123914	FOS43TASF	1	No	✓	✗	✗
2021123891	FOS43TASR	1	No	✗	✓	✗
<b>5" Monitor Camera Systems</b>						
2021123881	FOS05TASF	1	No	✓	✗	✗
2021123887	FOS05TASM	1	Yes	✗	✓	✗
2021123903	FOS05TAEN	3	Yes	✓	✗	✓
<b>7" Monitor Camera Systems</b>						
2021123576	FOS07TASF	1	No	✓	✗	✗
2021123882	FOS07TASR	1	No	✗	✓	✗
2021123904	FOS07TASM	1	Yes	✗	✓	✗
2021123862	FOS07TAEN	3	Yes	✓	✗	✓
2021123890	FOS07TAEM	3	Yes	✗	✓	✓
2021123885	FOS07TAPM	4	Yes	✓	✓	✓



# TECHNICAL INSTITUTE TRAINING



## Learn with us

With the Lippert Technical Institute, it's easy to get the training you and your employees need to successfully sell Lippert products. Contact us today to sign up for in-person or online courses!

## WHO WE TRAIN

### Technicians

- Gain a better understanding of how components come together and their functions
- Receive information on new products or updates on existing products
- Get hands-on experience on mock-ups that we build in house

### Sales

- Learn the features and benefits of Lippert products
- Become familiarized with Lippert Now app for smart phones and how to use it to your advantage

### Parts

- Learn about Lippert resources for parts identification
- Gain information on effective ways to communicate with technicians regarding replacement part kits
- Discover the advantages of using the Lippert Dealer Portal

### Warranty

- Learn about claims processing and processes Lippert NOW app and website
- Receive training on how to operate the interactive flat rate chart

## TYPES OF TRAINING

### Lippert technician service schools

- Three-day event covering multiple components
- Classes are completed with PowerPoint, hands-on instruction and troubleshooting
- Other suppliers offer classes at our schools
- This is our most extensive training and is hosted at our Lippert Technical Institute in Mishawaka, IN
- All technicians are welcome
- Limited space available, be sure to register

### Lippert regional training seminars

- One-day to three-day events covering multiple components
- These courses are seminar based and will have parts and pieces for demonstration
- Not full hands-on training as with our technician service schools
- Offered throughout the country multiple times a year

### Online webinars

- New courses released to our library monthly
- Create an account at [lippert.learnupon.com](http://lippert.learnupon.com)
- Courses can be accessed at any time
- Complete immediately or leave and come back at your convenience

## SCHEDULE YOUR TRAINING

View our current schedule at [support.lci1.com/technician-training](http://support.lci1.com/technician-training)  
Email us at [LCItraining@lci1.com](mailto:LCItraining@lci1.com)





WHENEVER, WHEREVER,  
WE MAKE YOUR EXPERIENCE BETTER.™

#### Connect With Us

Lippert | 432.LIPPERT | [lippert.com](http://lippert.com)

CURT | 877.287.8634 | [curtmfg.com](http://curtmfg.com)

All product names, logos, brands and other trademarks shown are the property of their respective trademark holders, and use of them does not imply any affiliation with or endorsement by them.